

3 WALL SECTION # 3
AIO 1/2" = 1"

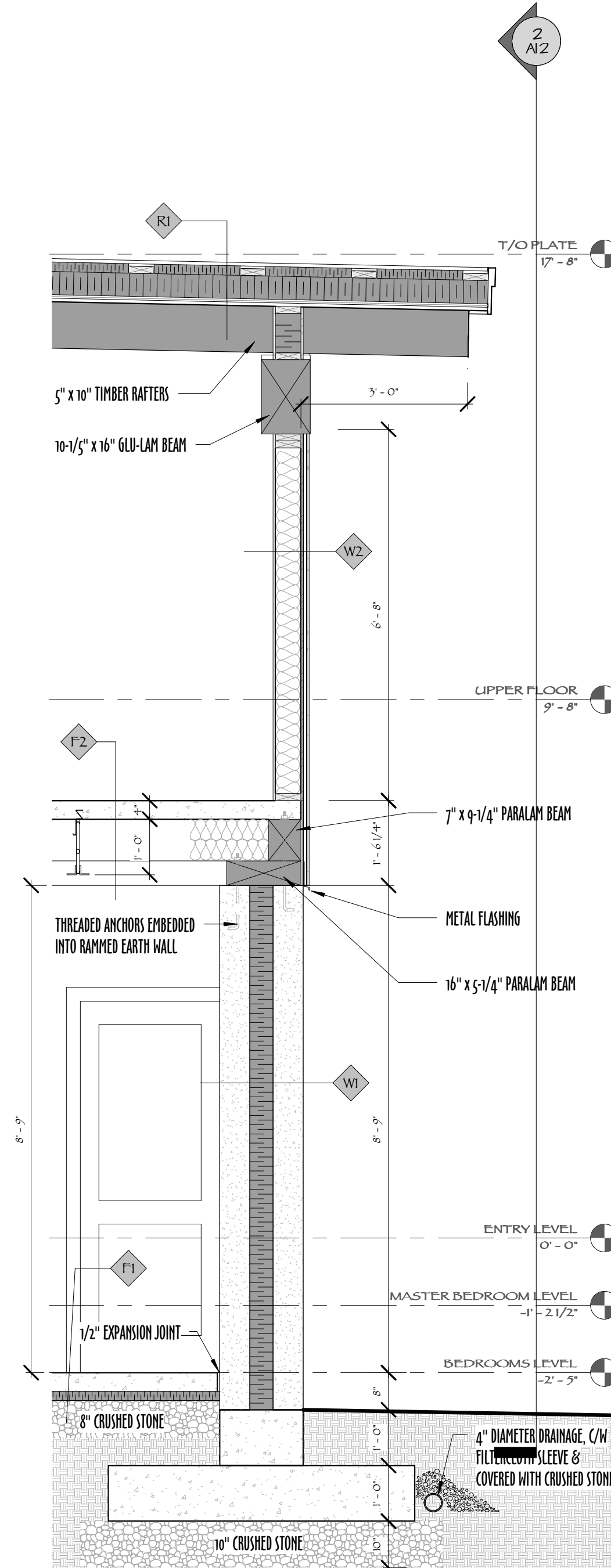

2 WALL SECTION # 2
AIO 1/2" = 1"

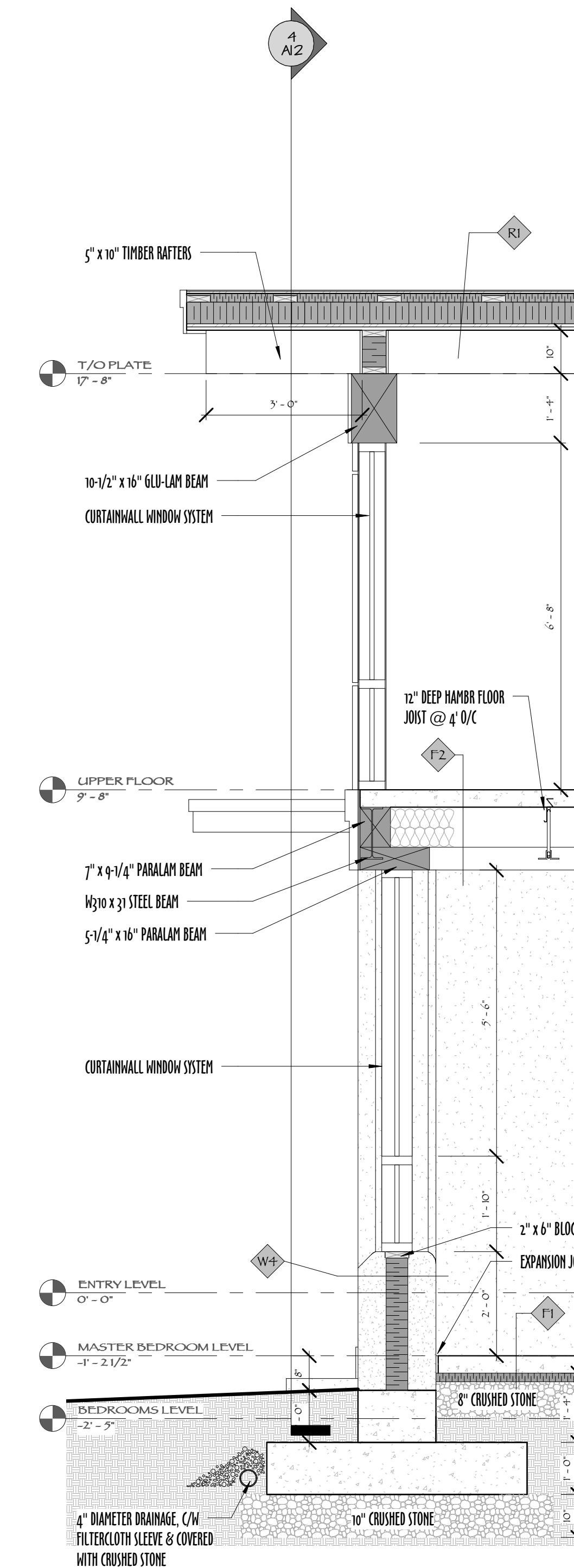

1 WALL SECTION # 1
AIO 1/2" = 1"

EXTERIOR WALL ASSEMBLIES:

W1: RAMMED EARTH WALL

- 6-1/2" RAMMED EARTH
- 5" RIGID INSULATION CORE
- 6-1/2" RAMMED EARTH

W2: 2" x 6" EXTERIOR WALL (PAPERSTONE FINISH)

- 1/2" PAPERSTONE FINISH
- 3/8" FURRING CHANNELS (VERTICAL)
- AIR / MOISTURE BARRIER (TAPED JOINTS)
- 1/2" PLYWOOD SHEATHING
- 2" x 6" STUDS @ 16" O/C C/W R20 BATT INSULATION
- ICNENE VAPOUR BARRIER PAINT
- 1/2" GYPSUM BD. FINISH

W3: 2" x 6" EXTERIOR WALL (VERTICAL WOOD SIDING FINISH)

- 1" VERTICAL WOOD SIDING FINISH
- 3/8" FURRING CHANNELS (HORIZONTAL)
- 2 LAYERS 30LB ROOFING FELT
- 3/8" FURRING CHANNELS (VERTICAL)
- AIR / MOISTURE BARRIER (TAPED JOINTS)
- 1/2" PLYWOOD SHEATHING
- 2" x 6" STUDS @ 16" O/C C/W R20 BATT INSULATION
- ICNENE VAPOUR BARRIER PAINT
- 1/2" GYPSUM BD. FINISH

FLOOR ASSEMBLIES:

F1: CONCRETE SLAB ON GRADE

- 4" POURED CONCRETE SLAB ON GRADE C/W WIRE MESH REINFORCING
- RADIANT FLOOR HEATING SYSTEM (HYDRONIC)
- 2" RIGID INSULATION
- 6" CRUSHED STONE

F2: CONCRETE SLAB ON HAMBRO JOISTS

- 4" POURED CONCRETE SLAB C/W WIRE MESH REINFORCING
- RADIANT FLOOR HEATING SYSTEM (HYDRONIC)
- 12" DEEP HAMBRO FLOOR TRUSS JOISTS @ 4'-0" O/C MAX.

F3: CONCRETE SLAB ON GLU-LAM FLOOR JOISTS

- 1-1/2" POURED CONCRETE SLAB C/W RADIANT FLOOR HEATING SYSTEM (HYDRONIC)
- 3/4" T&G PLYWOOD SHEATHING
- 3/4" T&G WOOD DECKING
- 4" x 10" GLU-LAM FLOOR JOISTS (2'-5" O/C MAX. - SPACING VARIES, REFER TO MAIN FLOOR STRUCTURE PLAN)

F4: ENTRY FLOOR SYSTEM

- TILE FINISH
- 5/8" T&G PLYWOOD SHEATHING
- 1-1/2" LIGHTWEIGHT CONCRETE (RADIANT FLOOR HEATING - HYDRONIC)
- 3/4" T&G PLYWOOD SHEATHING
- 4-1/2" T.J.I. FLOOR JOISTS @ 16" O/C

ROOF ASSEMBLY:

R1: FLAT ROOF

- 2 PLY TORCH-ON MEMBRANE
- 3/4" T&G PLYWOOD SHEATHING
- 7" RIGID INSULATION R20
- PEEL & STICK MEMBRANE
- 3/4" T&G PLYWOOD SHEATHING
- 3/4" T&G WOOD DECKING
- 5" x 10" TIMBER RAFTERS @ 2'-5" MAX (SPACING VARIES - SEE STRUCTURAL PLANS)

R2: SLOPED ROOF

- 2 LAYERS OF TORCH-ON ROOFING MEMBRANE
- 3/4" T&G PLYWOOD SHEATHING
- 7" RIGID INSULATION R20
- PEEL & STICK MEMBRANE
- 3/4" T&G PLYWOOD SHEATHING
- 3/4" T&G WOOD DECKING
- 5" x 10" TIMBER RAFTERS @ 2'-5" MAX (SPACING VARIES - SEE STRUCTURAL PLANS)