

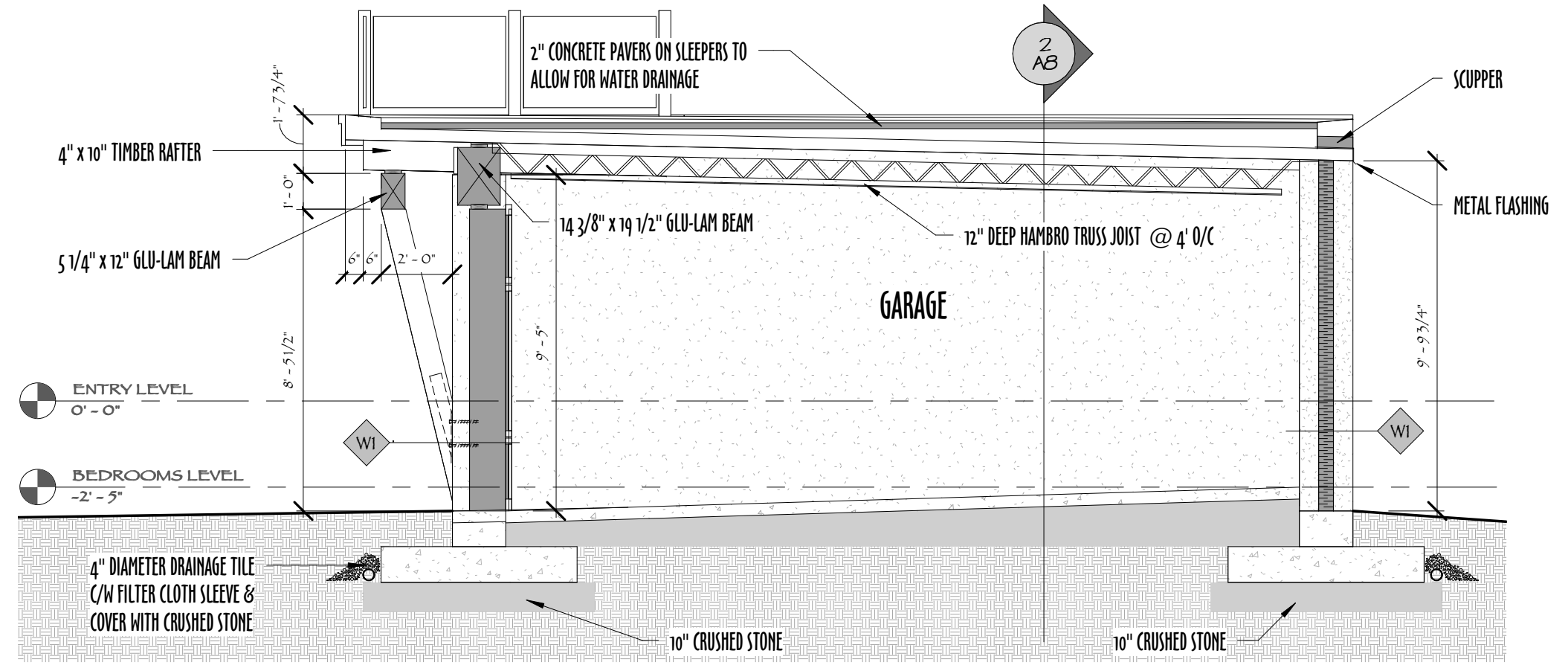

5 PARTIAL ELEVATION @ BEDROOM WING
 1/4" = 1'-0"

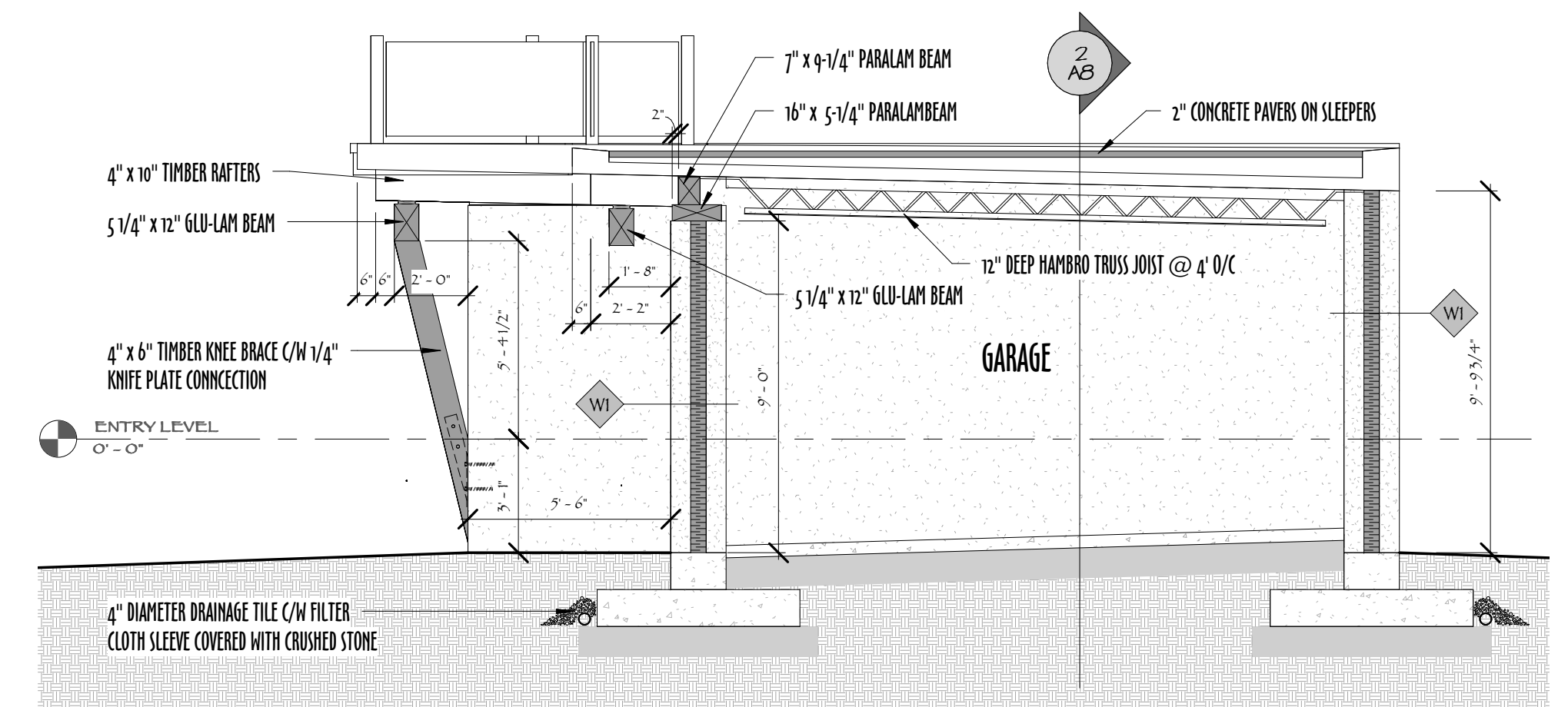

4 GARAGE SECTION 2
 1/4" = 1'-0"



3 GARAGE SECTION 1
 1/4" = 1'-0"

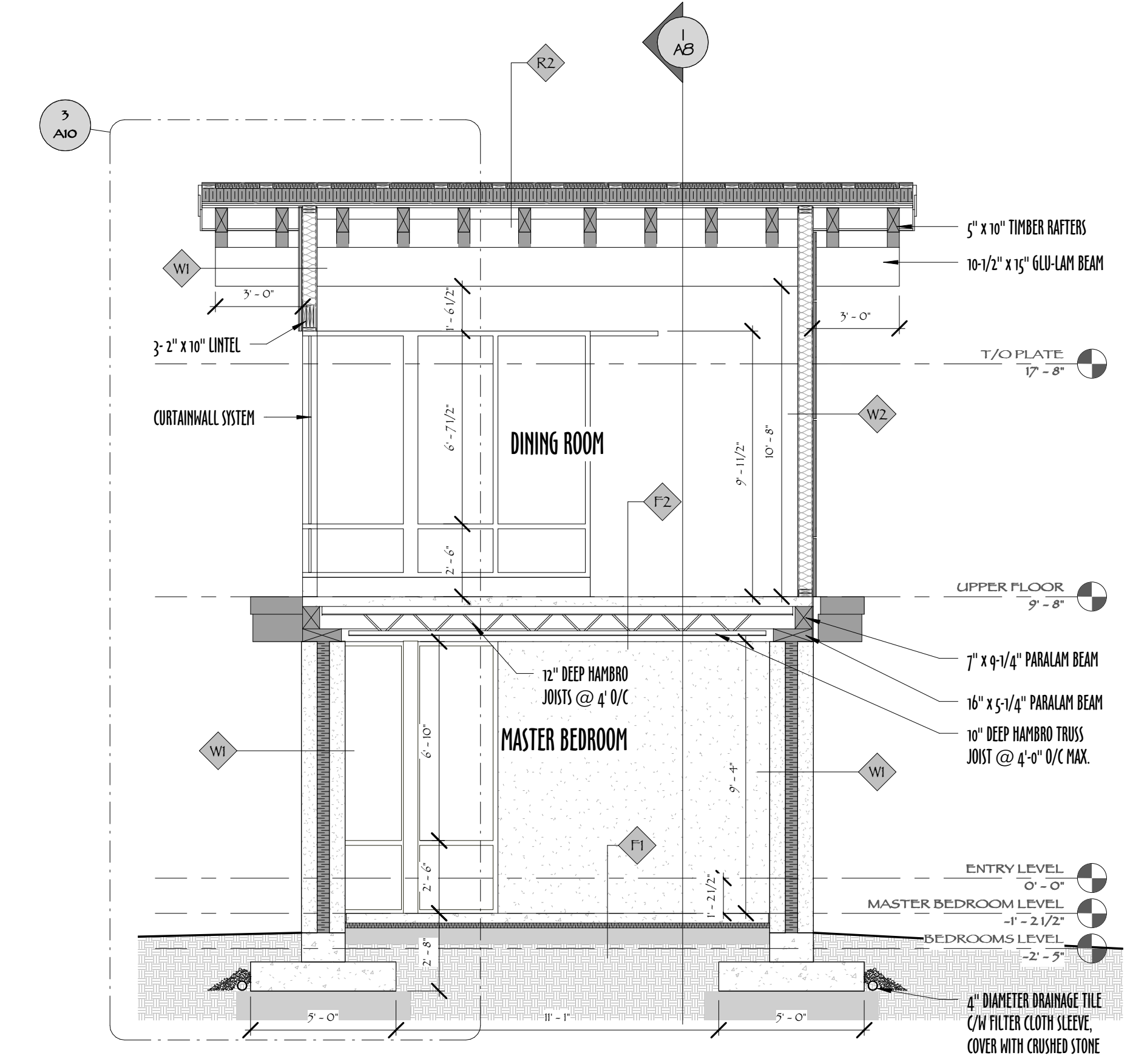

1 BUILDING SECTION 'D'
 1/4" = 1'-0"

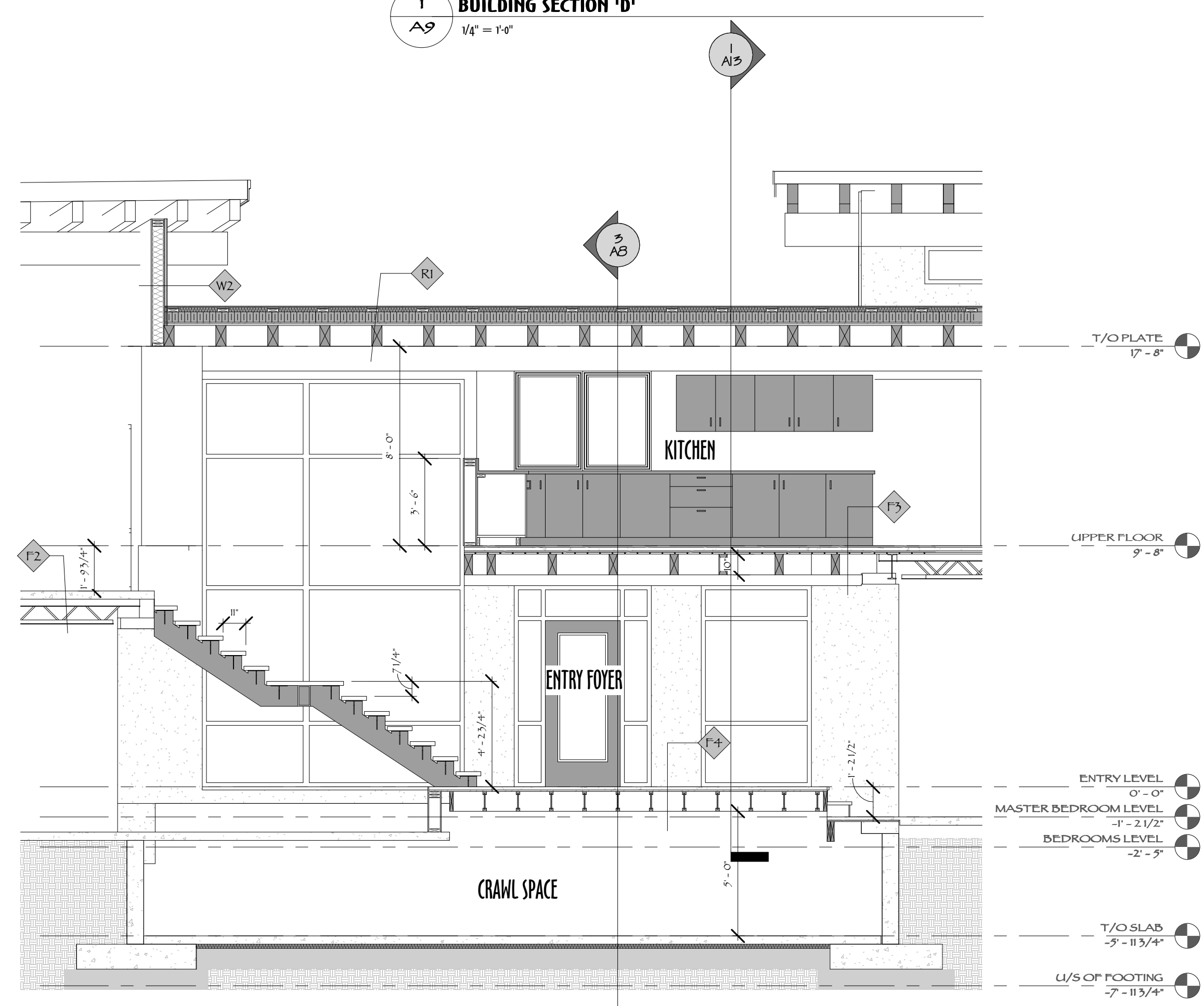

2 STAIR SECTION
 1/4" = 1'-0"

EXTERIOR WALL ASSEMBLIES:

- W1: RAMMED EARTH WALL**
 - 6-1/2" RAMMED EARTH
 - 5" RIGID INSULATION CORE
 - 6-1/2" RAMMED EARTH
- W2: 2" x 6" EXTERIOR WALL (PAPERSTONE FINISH)**
 - 1/2" PAPERSTONE FINISH
 - 3/8" FURRING CHANNELS (VERTICAL)
 - AIR / MOISTURE BARRIER (TAPED JOINTS)
 - 1/2" PLYWOOD SHEATHING
 - 2" x 6" STUDS @ 16" O/C C/W R20 BATT INSULATION
 - ICYNENE VAPOUR BARRIER PAINT
 - 1/2" GYPSUM BD. FINISH
- W3: 2" x 6" EXTERIOR WALL (VERTICAL WOOD SIDING FINISH)**
 - 1" VERTICAL WOOD SIDING FINISH
 - 3/8" FURRING CHANNELS (HORIZONTAL)
 - 2 LAYERS 30LB ROOFING FELT
 - 3/8" FURRING CHANNELS (VERTICAL)
 - AIR / MOISTURE BARRIER (TAPED JOINTS)
 - 1/2" PLYWOOD SHEATHING
 - 2" x 6" STUDS @ 16" O/C C/W R20 BATT INSULATION
 - ICYNENE VAPOUR BARRIER PAINT
 - 1/2" GYPSUM BD. FINISH

FLOOR ASSEMBLIES:

- F1: CONCRETE SLAB ON GRADE**
 - 4" POURED CONCRETE SLAB ON GRADE C/W WIRE MESH REINFORCING
 - RADIANT FLOOR HEATING SYSTEM (HYDRONIC)
 - 2" RIGID INSULATION
 - 6" CRUSHED STONE
- F2: CONCRETE SLAB ON HAMBR JOISTS**
 - 4" POURED CONCRETE SLAB C/W WIRE MESH REINFORCING
 - RADIANT FLOOR HEATING SYSTEM (HYDRONIC)
 - 12" DEEP HAMBR FLOOR TRUSS JOISTS @ 4'-0" O/C MAX.
- F3: CONCRETE SLAB ON GLU-LAM FLOOR JOISTS**
 - 1-1/2" POURED CONCRETE SLAB C/W RADIANT FLOOR HEATING SYSTEM (HYDRONIC)
 - 3/4" T&G PLYWOOD SHEATHING
 - 3/4" T&G WOOD DECKING
 - 4" x 10" GLU-LAM FLOOR JOISTS @ 5'-0" O/C MAX. - SPACING VARIES. REFER TO MAIN FLOOR STRUCTURE PLAN
- F4: ENTRY FLOOR SYSTEM**
 - TILE FINISH
 - 5/8" T&G PLYWOOD SHEATHING
 - 1-1/2" LIGHTWEIGHT CONCRETE (RADIANT FLOOR HEATING - HYDRONIC)
 - 3/4" T&G PLYWOOD SHEATHING
 - 9-1/2" T.J.I. FLOOR JOISTS @ 16" O/C

ROOF ASSEMBLY:

- R1: FLAT ROOF**
 - 2 PLY TORCH-ON MEMBRANE
 - 3/4" T&G PLYWOOD SHEATHING
 - 7" RIGID INSULATION R23
 - PEEL & STICK MEMBRANE
 - 3/4" T&G PLYWOOD SHEATHING
 - 3/4" T&G WOOD DECKING
 - 5" x 10" TIMBER RAFTERS @ 2'-5" MAX (SPACING VARIES - SEE STRUCTURAL PLANS)
- R2: SLOPED ROOF**
 - 2 LAYERS OF TORCH-ON ROOFING MEMBRANE
 - 3/4" T&G PLYWOOD SHEATHING
 - 7" RIGID INSULATION R23
 - PEEL & STICK MEMBRANE
 - 3/4" T&G PLYWOOD SHEATHING
 - 3/4" T&G WOOD DECKING
 - 5" x 10" TIMBER RAFTERS @ 2'-5" MAX (SPACING VARIES - SEE STRUCTURAL PLANS)